

# **ahead RC** Crawler

## 1/10 Offroad Expedition Trailer

### Assembly Manual

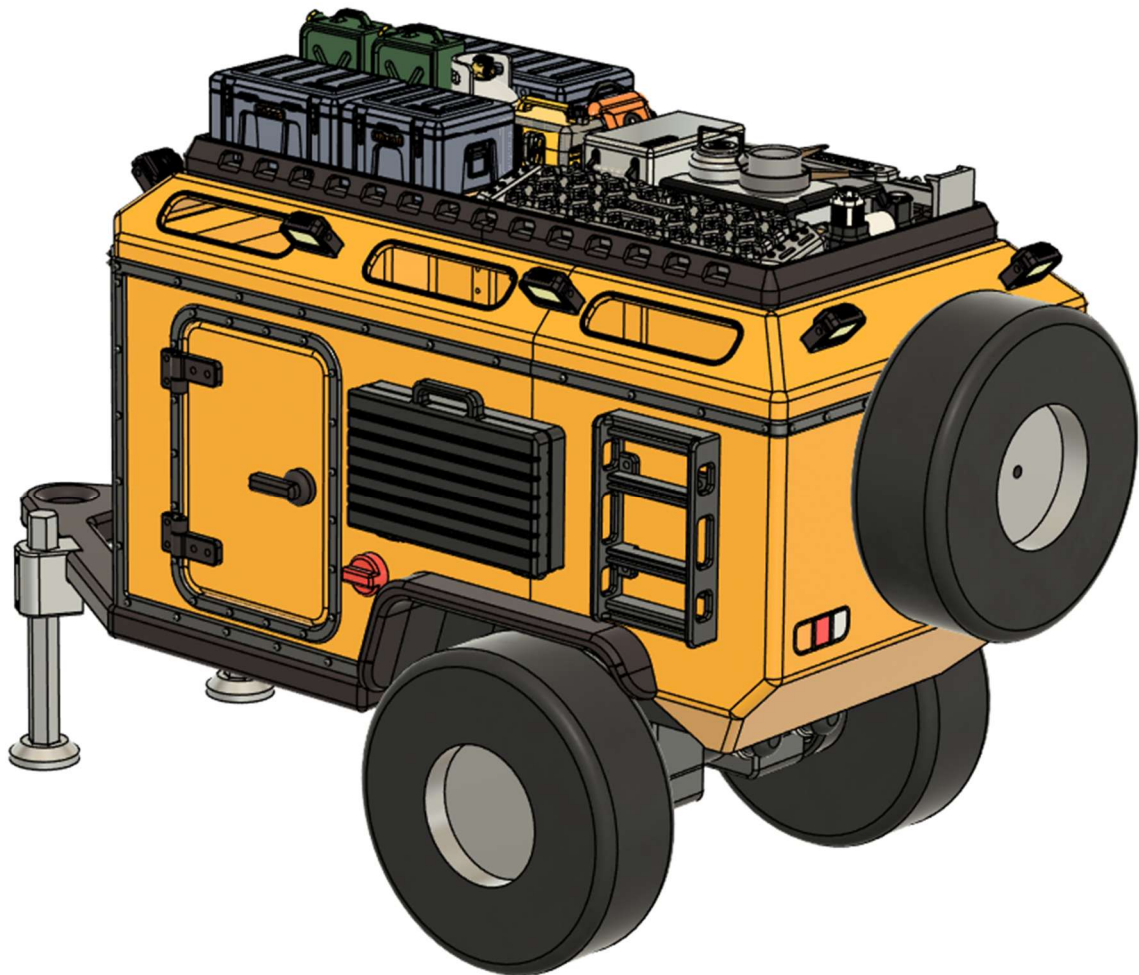

## Required tools and hardware

### Tools

- 1.5mm Hex Driver
- 1.5mm L shape hex wrench
- 2.0mm Hex Driver
- 2.5mm Hex Driver
- 2.5mm L shape hex wrench
- 3mm drill bit
- Needle Nosed Pliers
- Instant Glue
- Hot Glue

### Electronics

- 3mm LED White x10
- 3mm LED Red x2
- 3mm LED Orange x2

### Hardware

Hardware	Quantity	Hardware	Quantity
M2*5 Socket head	44	M3*25 Countersunk (CS)	8
M2*8 Socket head	20	M3x5 Grub Screw (GS)	4
M2*10 Socket head	14	M4x25 Socket head	2
M2*15 Socket head	5	M4x40 Socket head	1
M3*10 Socket head	27	M4 Nut	4
M3*15 Socket head	20	12x4mm magnet	12
M3*20 Socket head	8	10x2mm magnet	4
M3*20 Countersunk (CS)	6		

# Before you begin

- Be sure to read through the manual and familiarise yourself with the instructions
- Visualise a plan to assemble all the pieces
- Make sure you have all of the hardware and tools
- Be sure to have enough instant glue
- Dry fit all parts before painting and assembling

Tip: It will help to paint all of the parts before final assembly

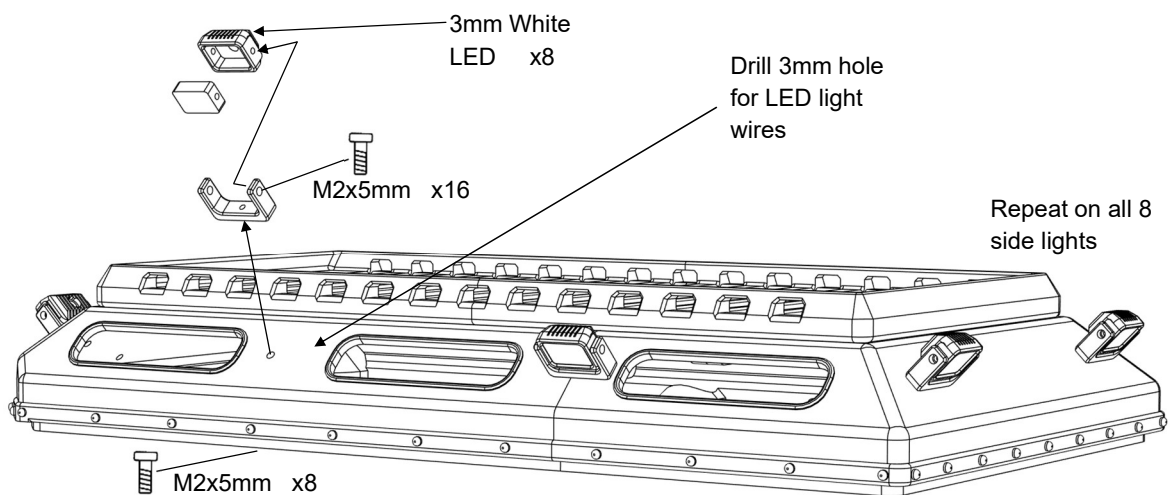
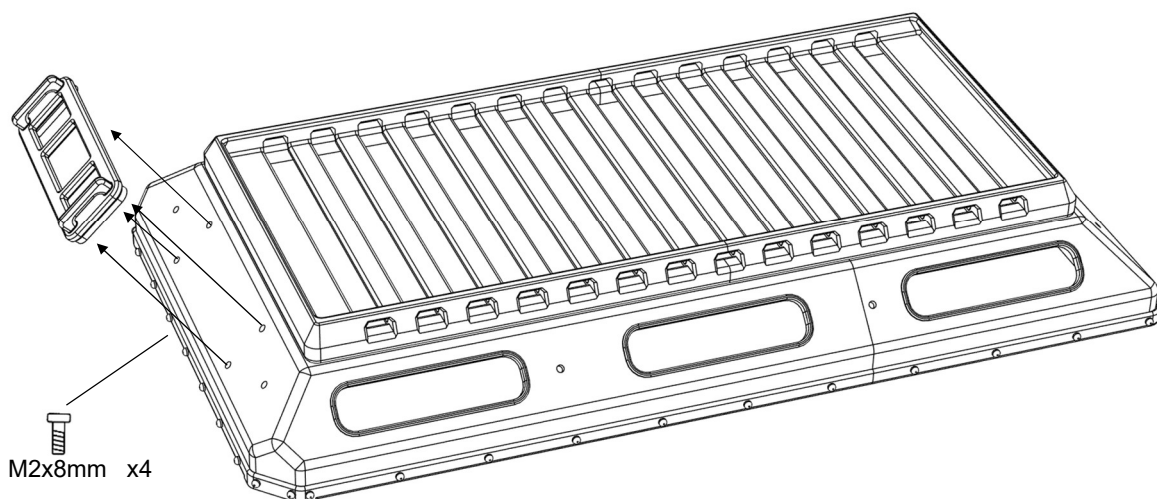
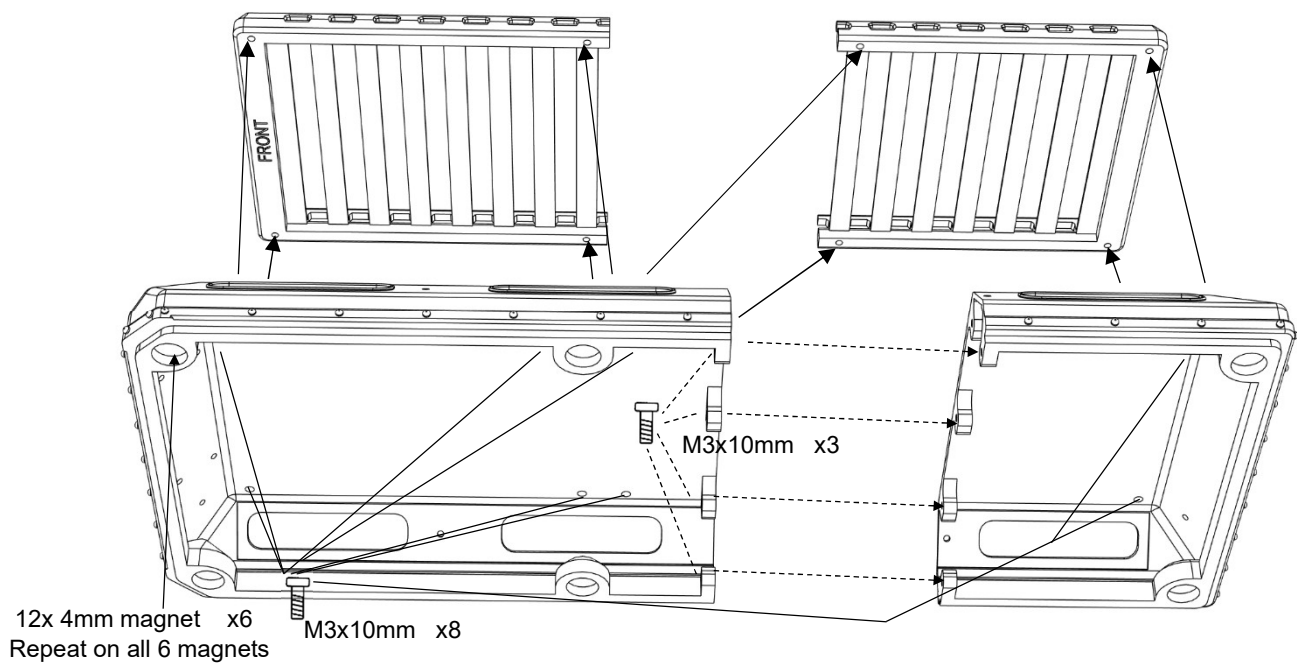

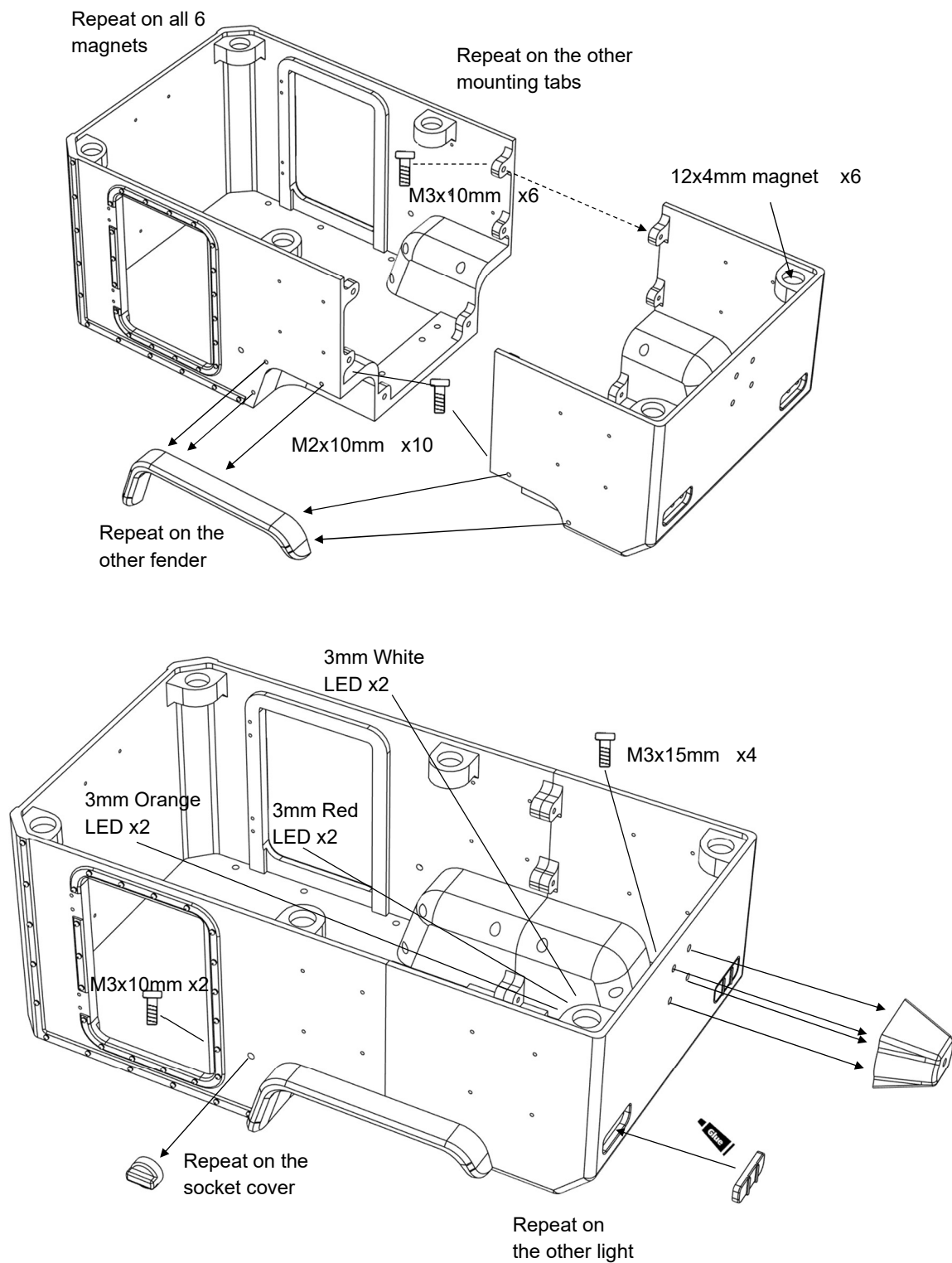

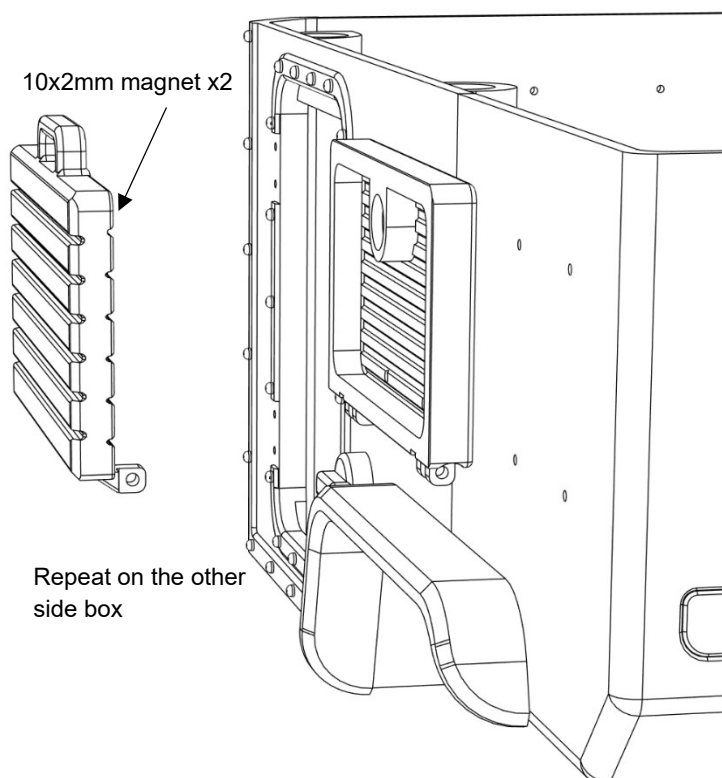
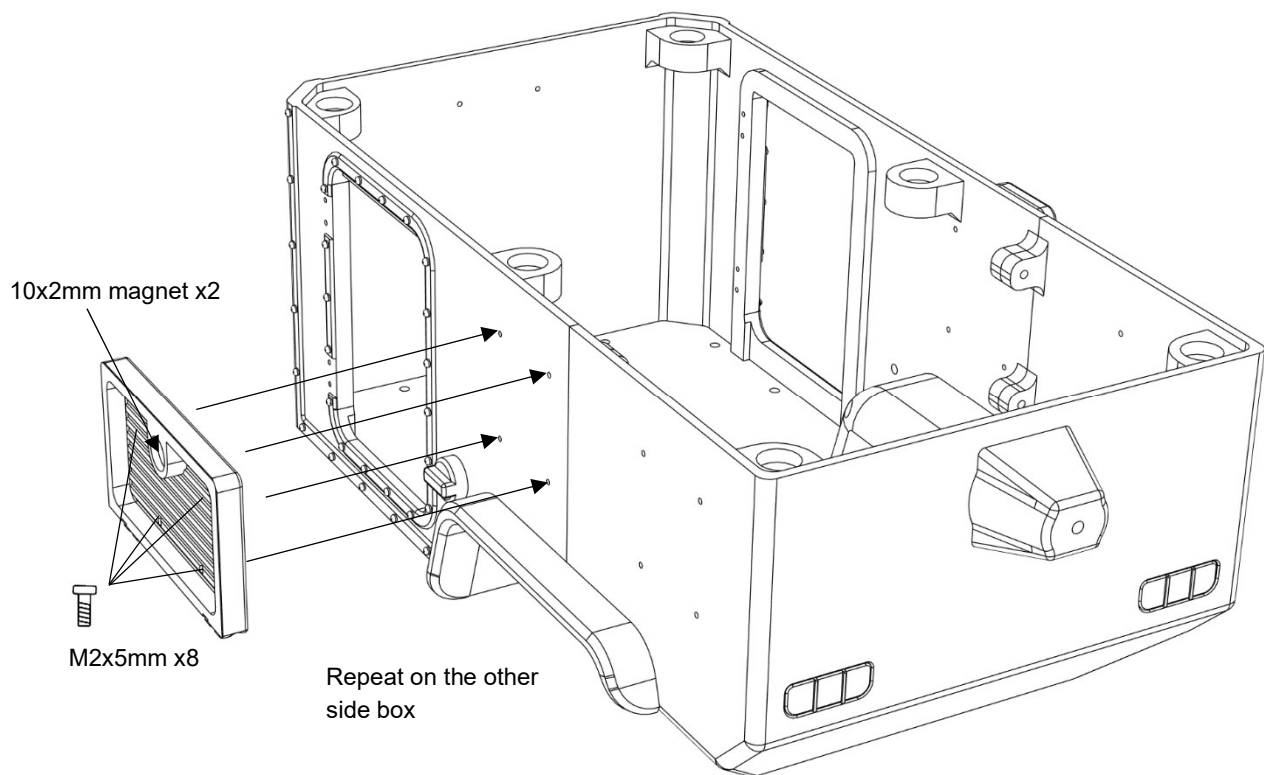

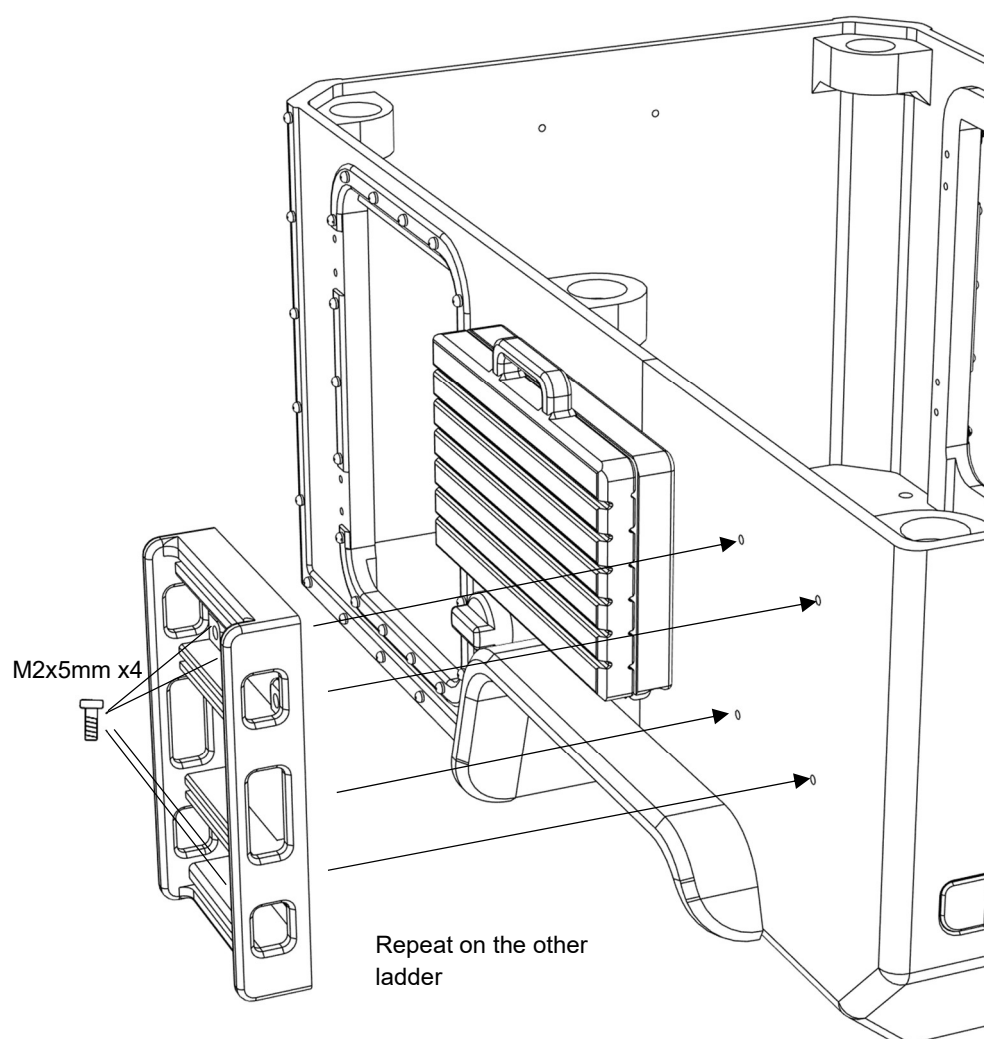
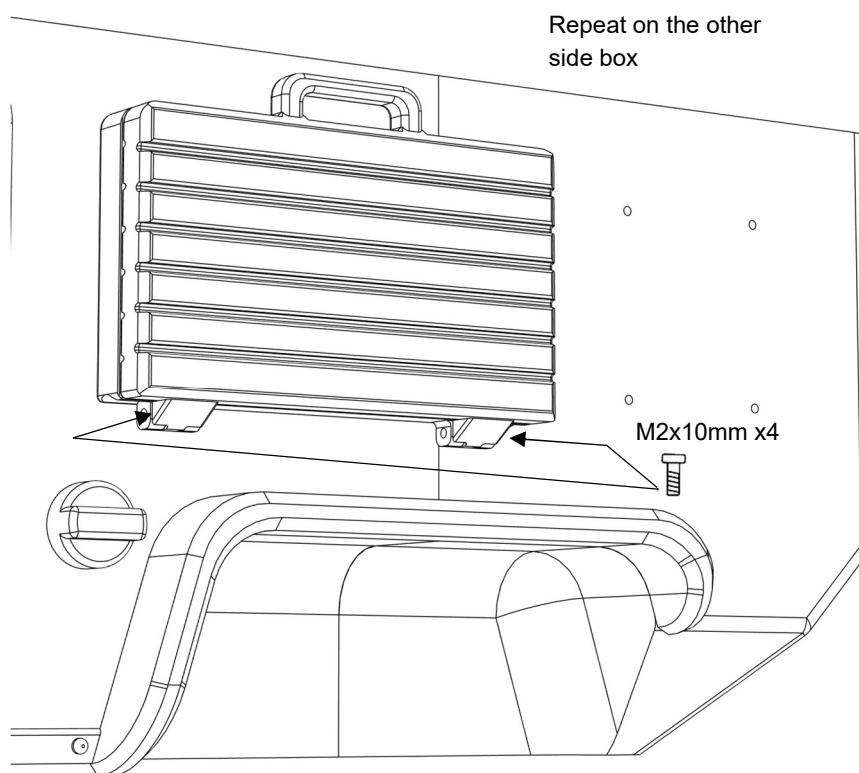

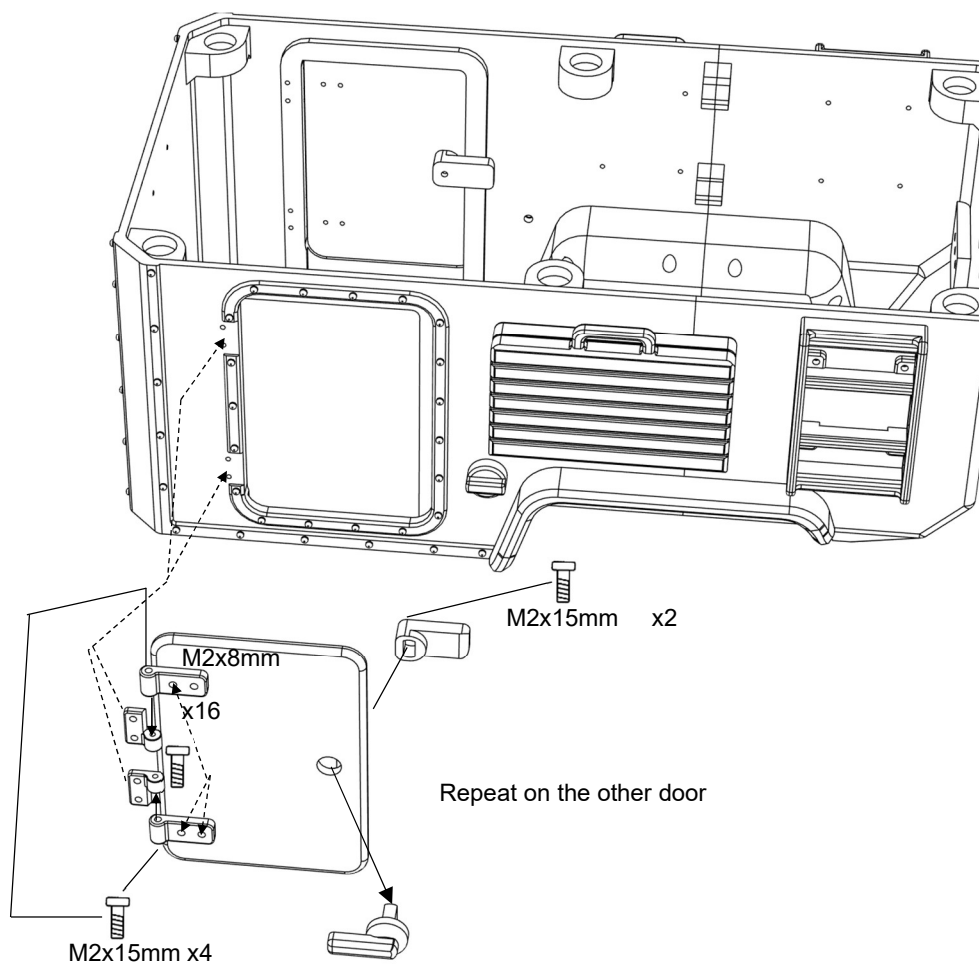

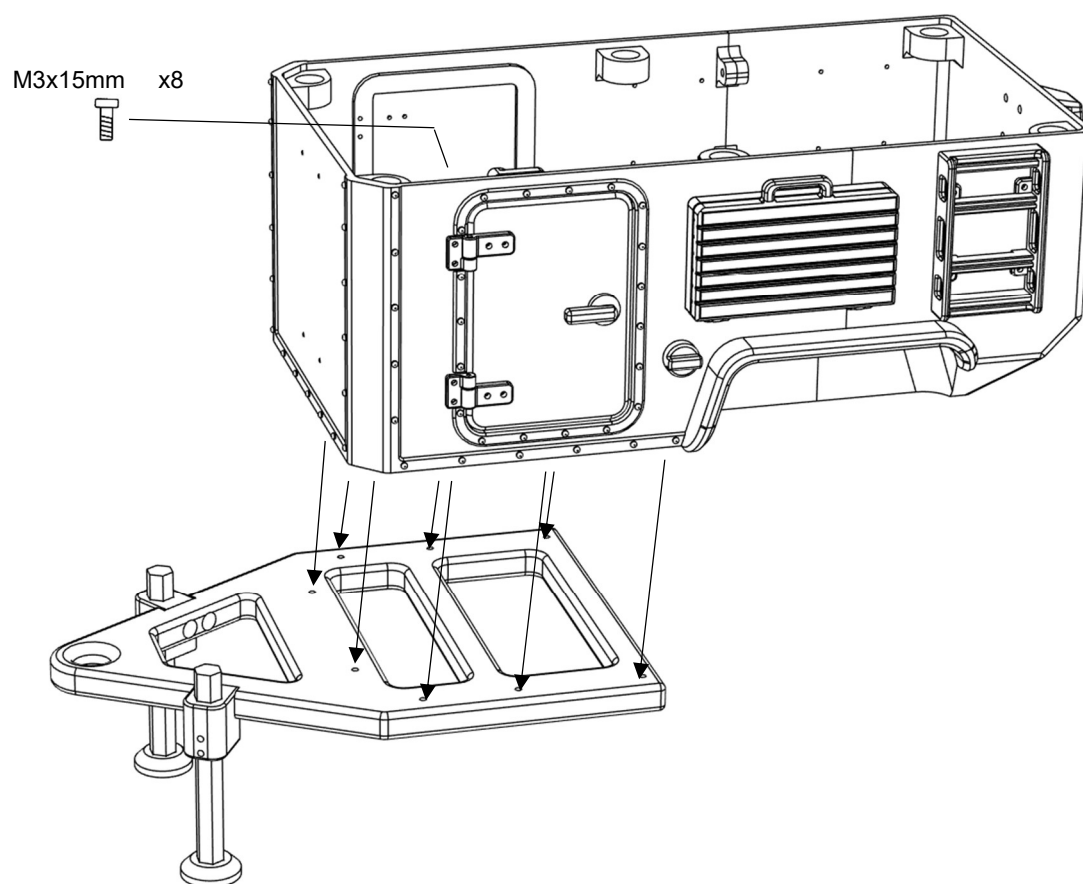
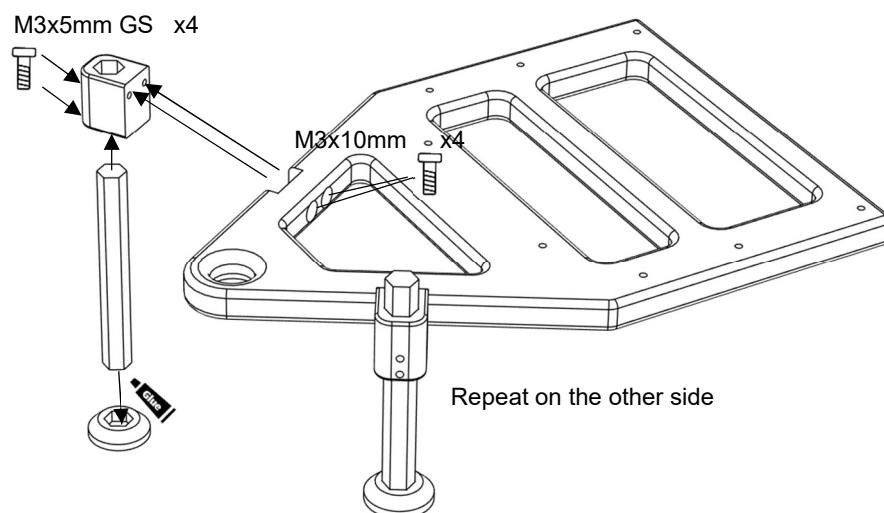

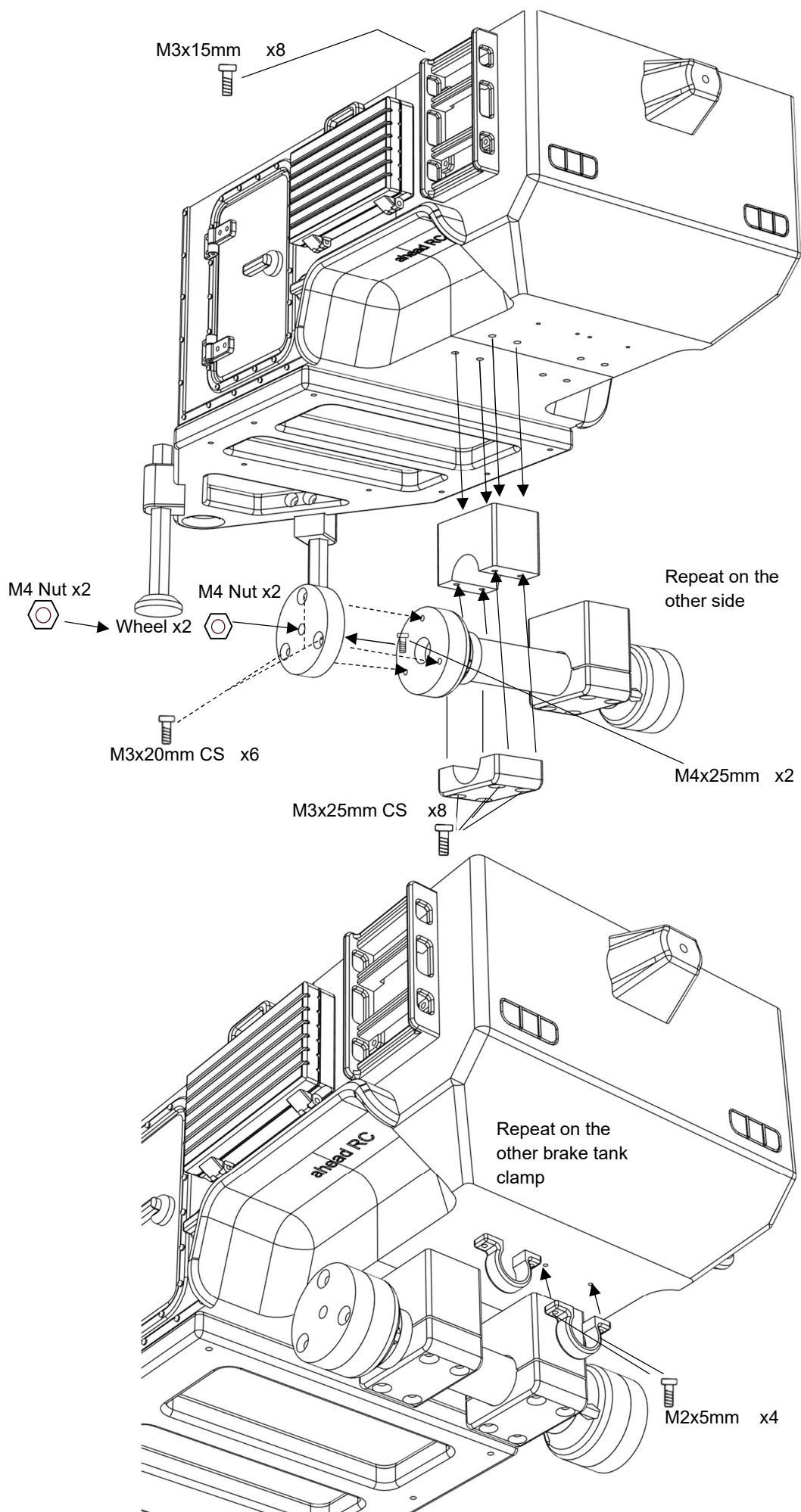

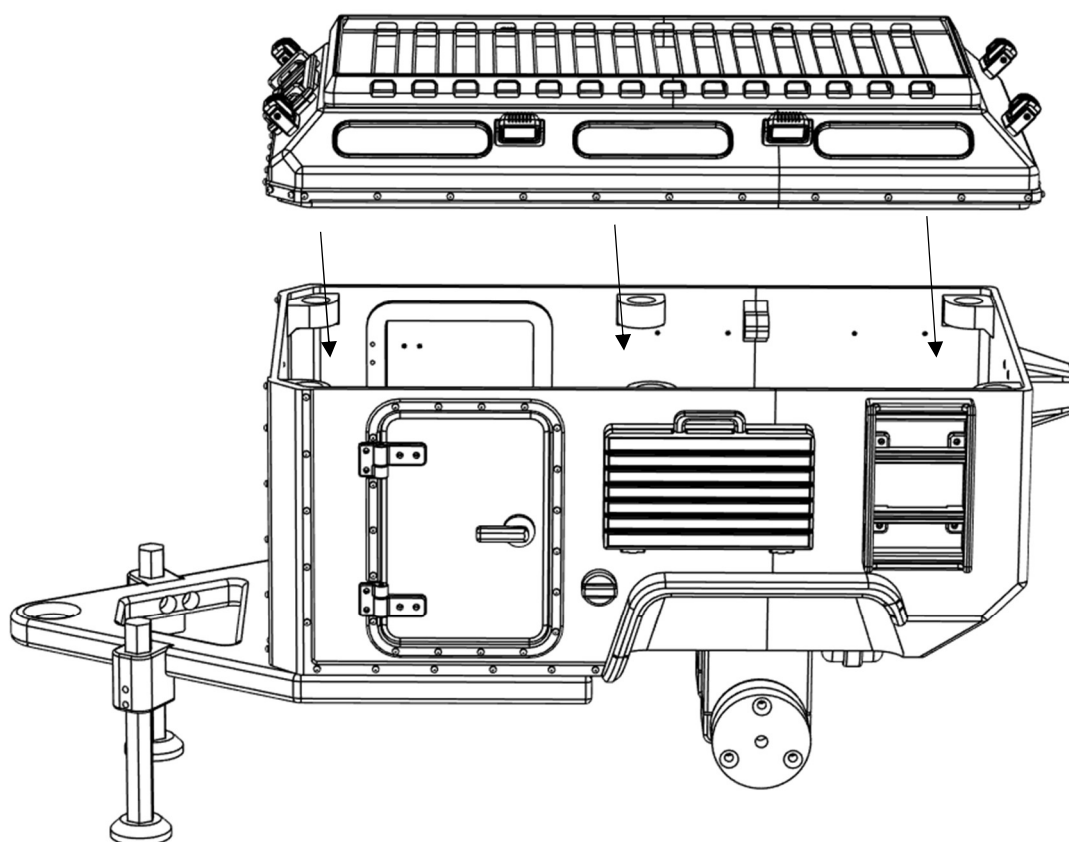
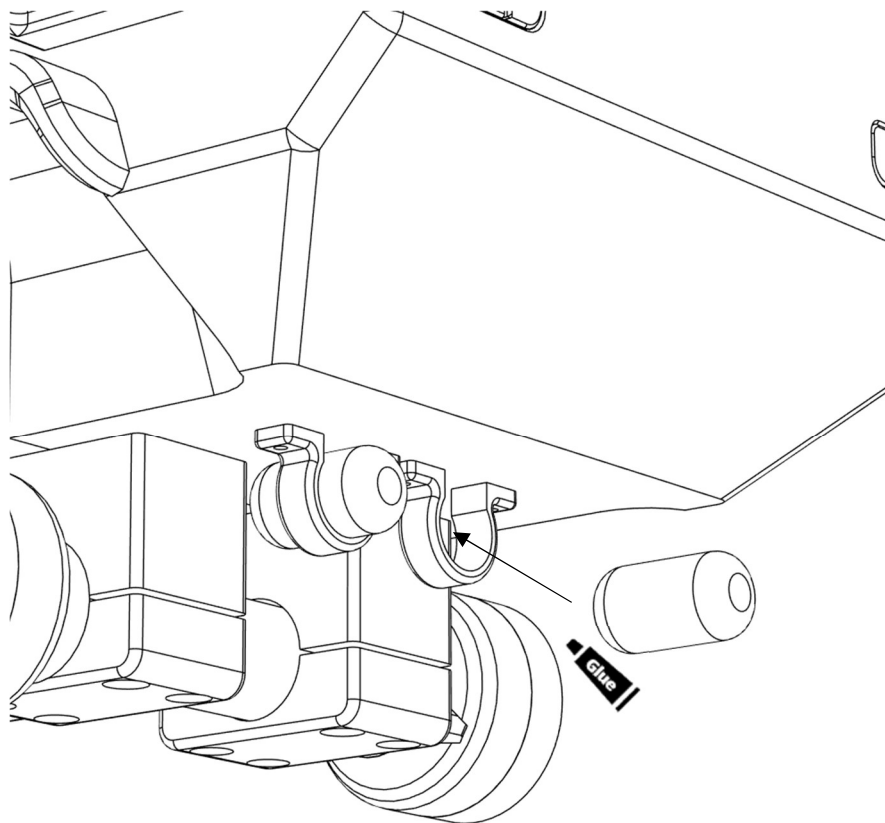

Install accessories.  
Uses double sided  
tape or hot glue to  
secure

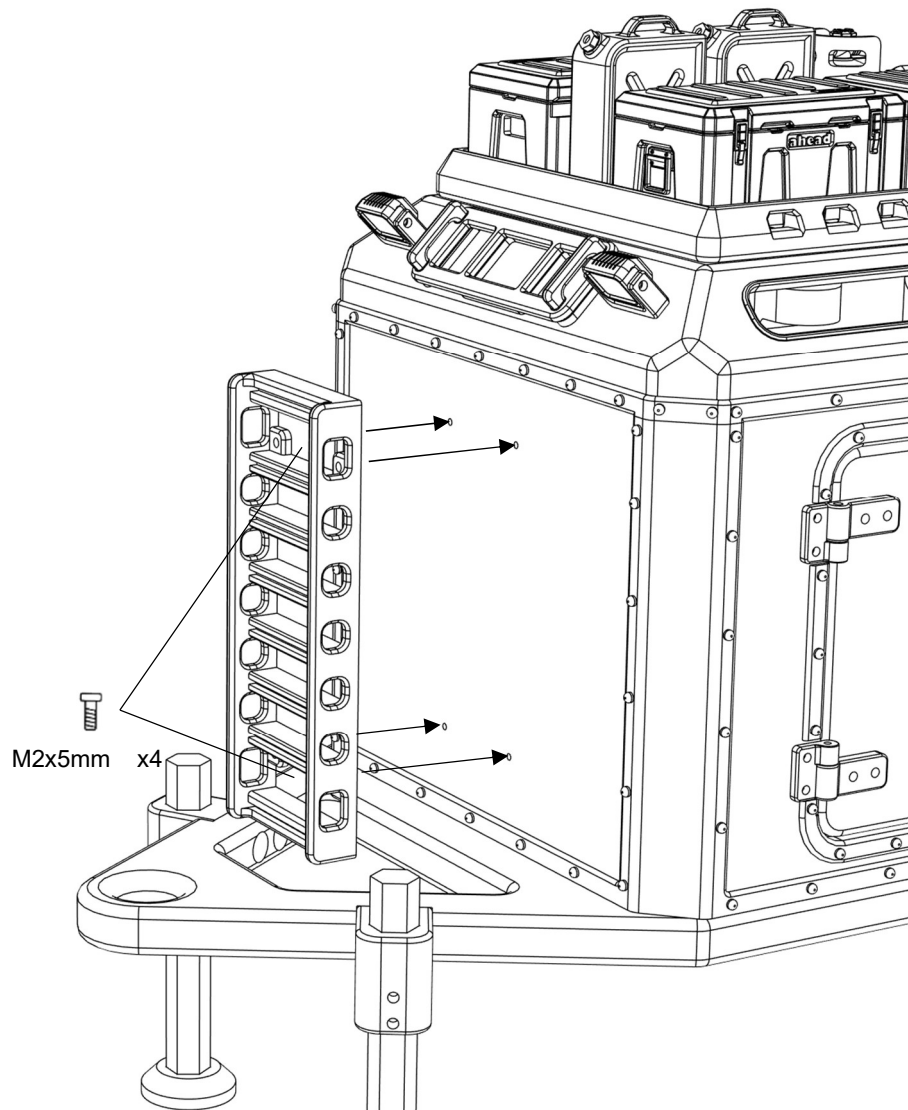
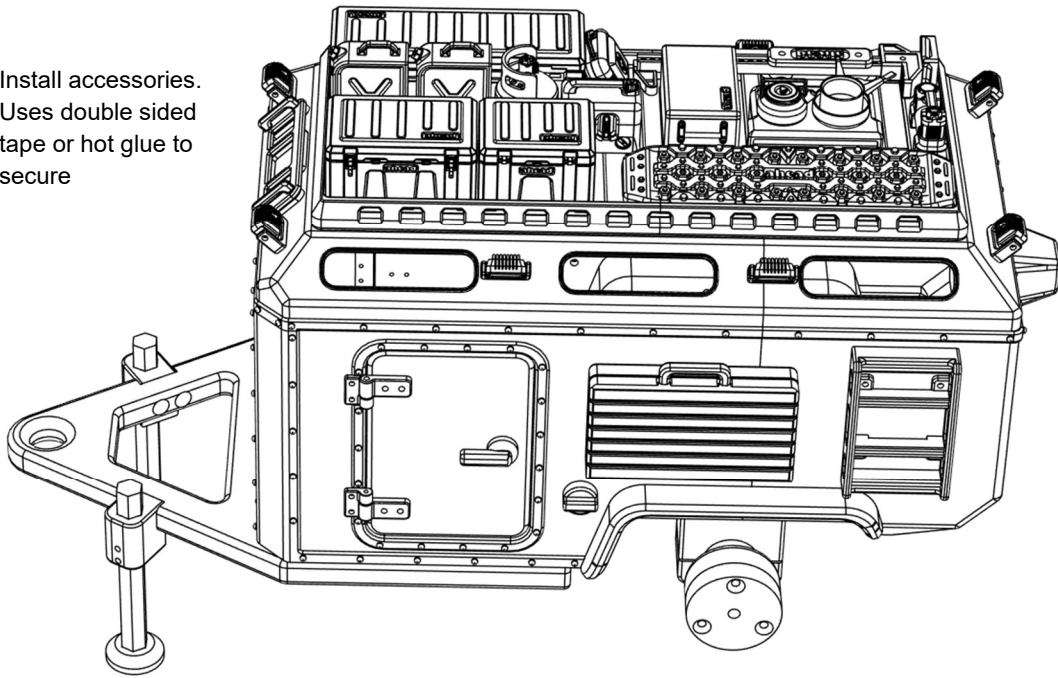

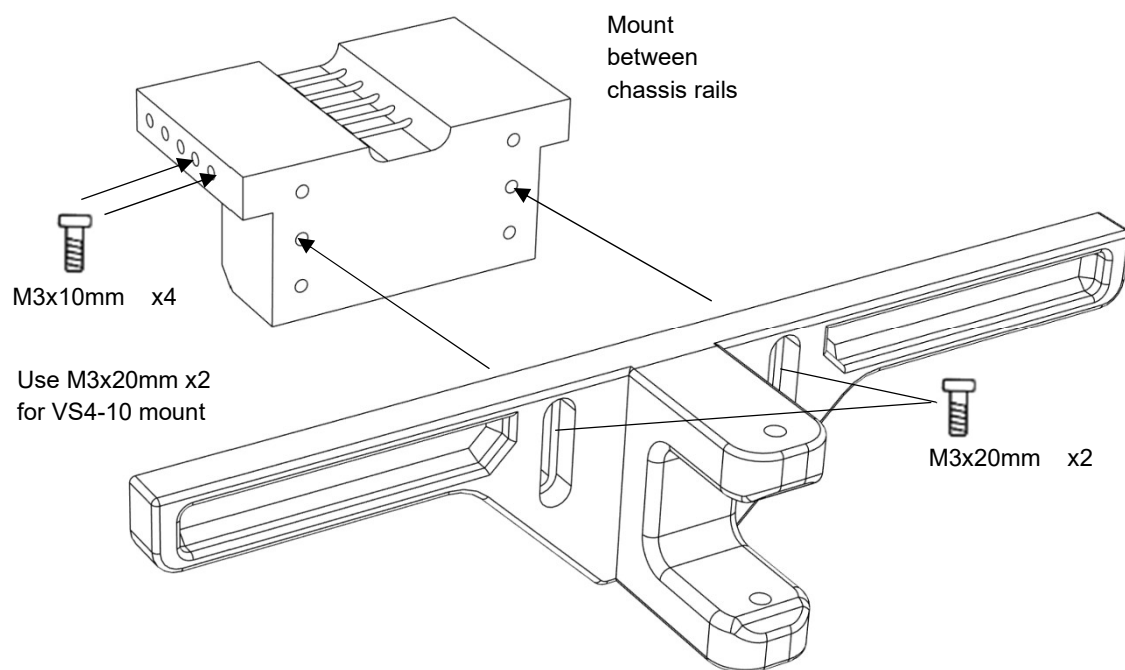
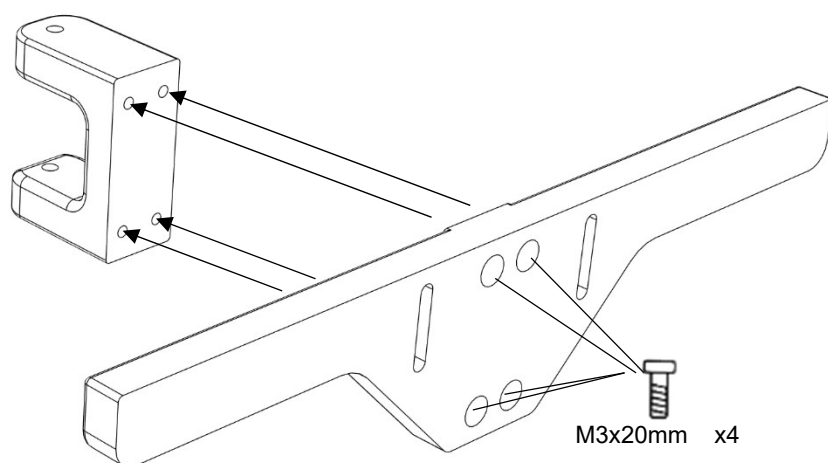

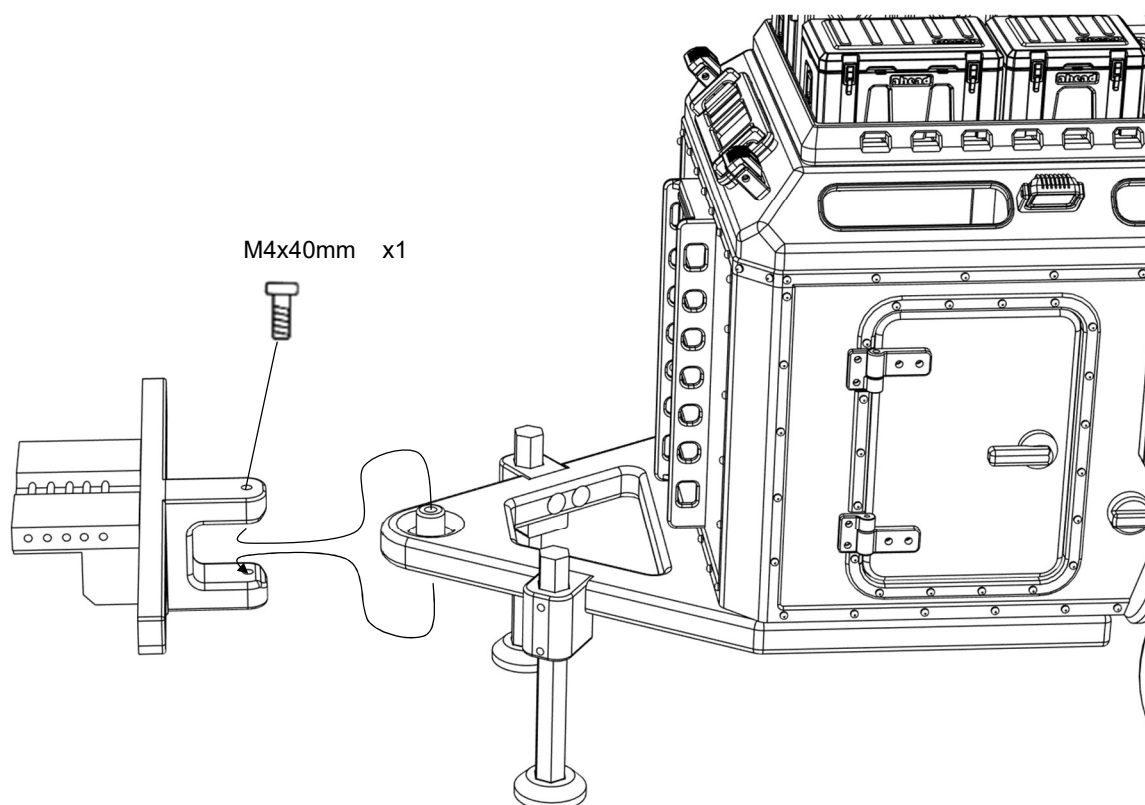
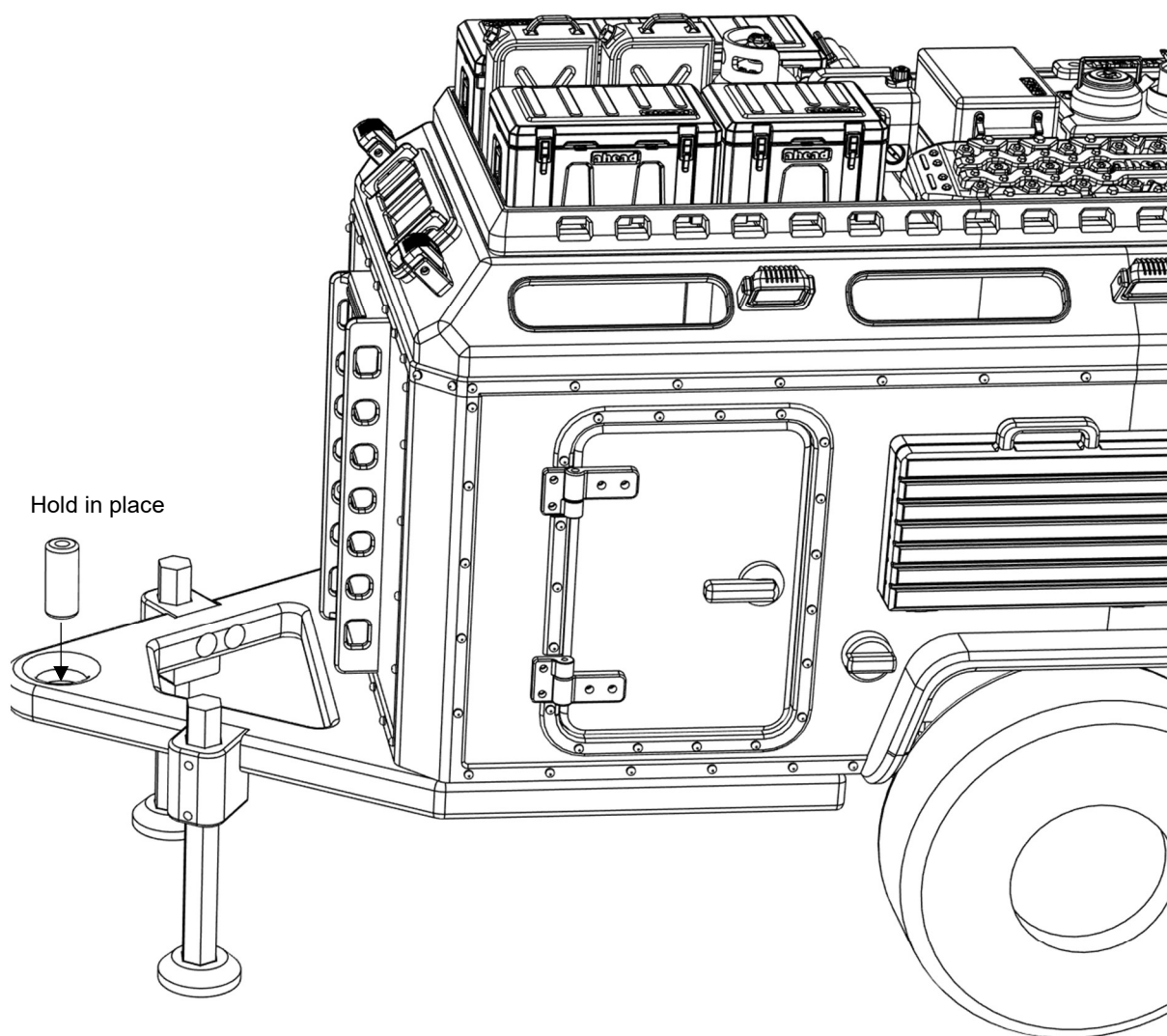

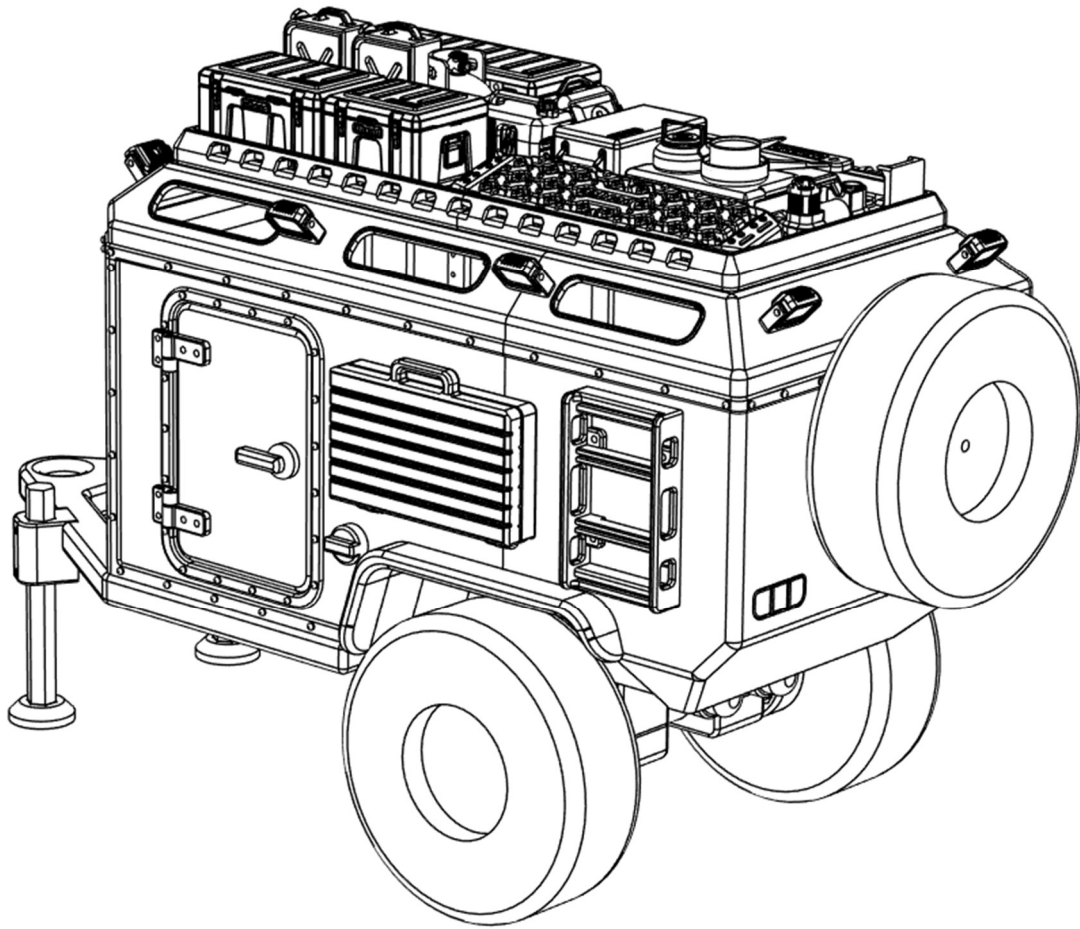

Body is now fully complete. Thank you for selecting ahead RC products.

If you have any questions or need help with the assembly, please do not hesitate to contact us at:

[aheadrc@gmail.com](mailto:aheadrc@gmail.com)

or visit us at:

[www.aheadrc.com](http://www.aheadrc.com)